

valco  
baby

# HITCH HIKER

Ride On Stand

## PRODUCT REFERENCE GUIDE

Thank you for purchasing a quality VALCO BABY product. Please read and follow the instructions outlined in this guide carefully. Familiarise yourself with the construction and safety features; be sure that you understand all the warnings and safety guidelines before use.

**Important: Please read the following instructions carefully before assembling this product. Retain this guide in a safe place for future reference.**



**Standard Model**



**Concealed  
Brake Model**

Due to our policy of continuous product development, this product is constantly evolving. It is possible that some features or procedures outlined here have changed since this document was written. If you are unsure of any procedure shown here, please contact us via the web at [info@valco.com.au](mailto:info@valco.com.au) to obtain the most up to date information before use. Include the batch number, which can be found on a sticker on the frame.

All pictures and diagrams herein are provided for illustration purposes only. Actual product, colour or fabric may vary. VALCO BABY reserves the right to modify or alter any specification or colour without notice or obligation to modify any product previously purchased

### FURTHER INFORMATION

In Australia/New Zealand

[www.valco.com.au](http://www.valco.com.au)

In North America only

[www.valcobaby.com](http://www.valcobaby.com)  
1800 610 7850



© Copyright VE 2010  
vs050810

# ASSEMBLY

FIGURE A - CONTENTS

1. Check contents and confirm your model type (Standard or Concealed Brake). Please dispose of all packaging thoughtfully.

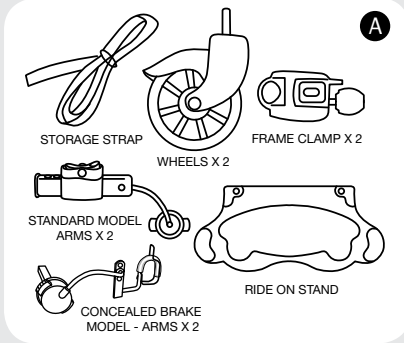

FIGURE B

2. Insert the board swivel wheel into the housing on the underside of the board
3. Firmly press the pin into the housing until it locks into place.
4. Repeat for the other wheel

**If you have the Concealed Brake Model, skip to Figure H.**

FIGURE C - Standard Model only

5. Remove the fastening strap from the frame clamp by turning the knob anti-clockwise until it is released from the lock core.
6. Pull the fastening strap from the frame clamp.

FIGURE D- Standard Model only

7. Identify an open unencumbered space on each of the upright leg tubes of the pram or stroller to which you will attach the HitchHiker stand.
8. Wrap the fastening strap around each tube at the height which is reachable by the fastening arms. (You will notice that the strap conforms to the size/shape of the tube.)
9. Lock the flexible tube strap in the ridges of the strap housing.

FIGURE E - Standard Model only

10. Holding the strap firmly locked into the housing, slide the frame clamp over the strap until the strap exits through the side slot on one side and the thread through the exit hole on the other side.

FIGURE F - Standard Model only

11. Secure the knob and tighten.
12. Repeat this procedure for the opposite side.

FIGURE G - Standard Model only

13. If the Length Adjuster Switch (LAS) impedes the operation of your pram or stroller's brakes, your HitchHiker can be assembled with the LAS facing downward. To do so, depress the LAS and pull it all the way back, until it is completely disengaged from the housing. Turn it over so that the LAS is facing downward, and re-engage it on to the housing. Repeat for the other side.

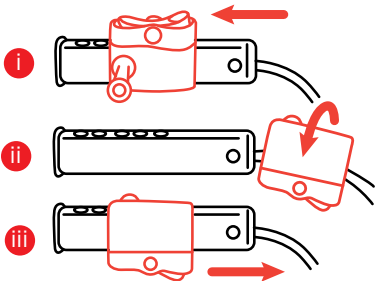
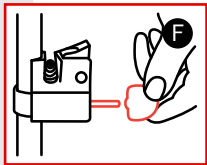
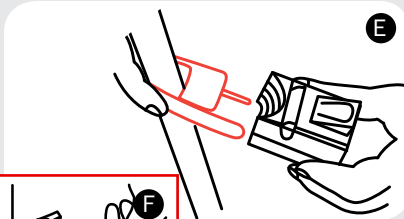
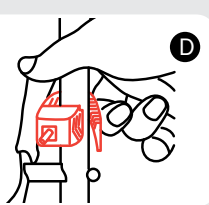
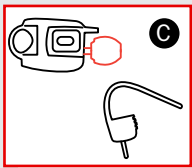
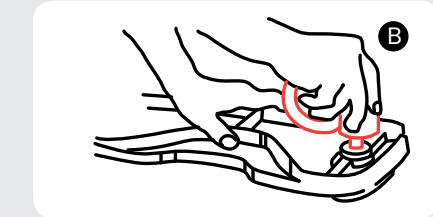

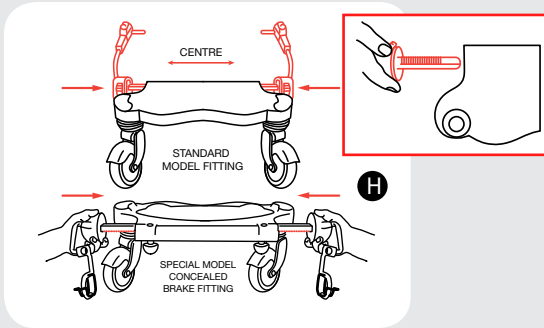

FIGURE H - Standard & Concealed Brake Model  
14. Insert each of the arms into the board channel on either side.

**IMPORTANT NOTE: MAKE SURE THAT THE RIDGED EDGE ON THE ARMS ALWAYS FACES DOWNWARD**

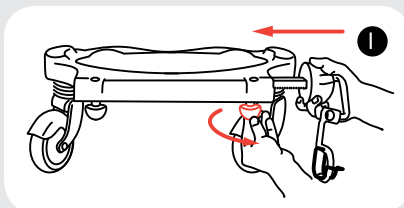

FIGURE I - Standard & Concealed Brake Models  
15. Centre the board behind the stroller by adjusting the insertion of each of the arms in each channel accordingly. Lock the position by tightening the two screws on the underside of the board.

**If you have the Concealed Brake Model skip to Figure M**

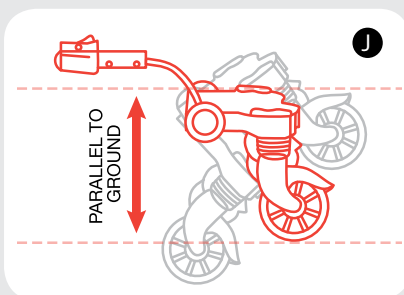

FIGURE J - Standard Model  
16. Ensure that the board is as parallel as possible to the ground by turning the arm adjusters. To do this, simultaneously press the buttons and turn the board until it is as horizontal as possible to the ground.

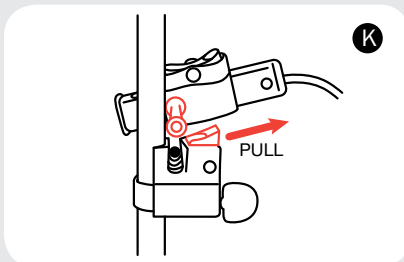

FIGURE K- Standard Model  
17. Attach the arms to the stroller by placing the securing rivet over the channel in the frame clamp.  
18. Pull the spring loaded cover back to open the channel.  
19 Insert the securing rivet firmly into the channel and release the cover.  
20. Repeat for the other side.

**Test to make sure that all rivets are secure in their corresponding channels.**

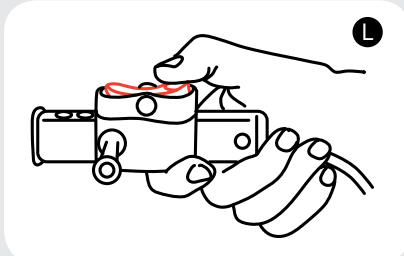

FIGURE L - Standard Model  
21. Adjust the distance of the board from the stroller by depressing the rocker switch on each arm and moving the arms forward or backwards to the desired position.

**If you have the Standard Model skip to Figure O**

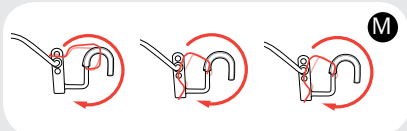

FIGURE M - Concealed Brake Model

22. Lift and release the clamp guard fully backward. (Be careful, as if it is not fully lifted, it can spring back to place and hit your hand.)

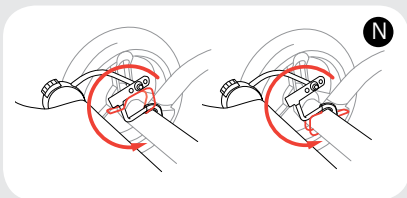

FIGURE N - Concealed Brake Model

23. Place the clamp over the rear axle of your stroller  
24. Secure the clamp to the stroller engaging the clamp guard.

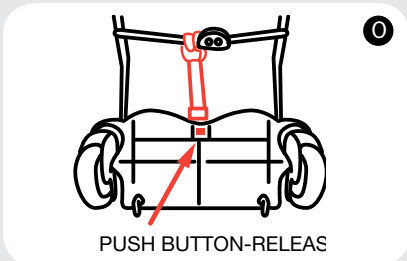

FIGURE O - For Standard Model and Concealed Brake Models

25. Attach the strap to our stroller handle by looping it over the bar and securing by threading it through the sewn loop.  
26. You can conveniently 'fold' your HitchHiker out of the way by lifting it and securing it to the strap by inserting the strap buckle through the slot in the board.  
27. Adjust the strap length using the slider buckle. Ensure the strap is tight, lifting the entire unit as much 'out of the way' as possible.  
28. To release, press the buckle tongue on the underside of the stand, ease the buckle out of the board and gently lower the unit to the ground.

## WARNING

- FOLLOW THE MANUFACTURER'S INSTRUCTIONS.
- PUT ON ALL THE BRAKES WHENEVER YOU PARK THE PRAM/STROLLER.
- DO NOT LEAVE CHILDREN UNATTENDED.
- DO NOT CARRY EXTRA CHILDREN ON THIS PRODUCT.
- MAKE SURE CHILDREN ARE CLEAR OF ANY MOVING PARTS IF YOU ADJUST THE PRAM/STROLLER. OTHERWISE THEY MAY BE INJURED.

Remember, your child's safety is your responsibility...

- BE SURE THAT ALL CLAMPS AND BUCKLES ARE SECURELY FIXED INTO PLACE BEFORE USE.
- THE MAXIMUM WEIGHT OF THE CHILD FOR WHICH THE PRODUCT IS INTENDED IS UP TO 30KG'S.
- RECOMMENDED FROM APPROXIMATELY 2 YEARS PLUS.
- YOUR CHILD'S FEET SHOULD BE COMPLETELY STANDING ON THE DIMPLED/NON SLIP PART OF THE HITCHHIKER RIDE ON STAND.
- YOUR CHILD SHOULD NEVER BE LEFT UNATTENDED WHILE ON THE HITCHHIKER RIDE ON STAND.
- CHILDREN IN THE STROLLER MUST ALWAYS WEAR A SAFETY HARNESS, CORRECTLY FITTED AND ADJUSTED, AT ALL TIMES.
- ALWAYS KEEP YOUR HAND ON THE PRAM HANDLE WHEN YOUR CHILD IS USING THE HITCHHIKER RIDE ON STAND
- CHECK ALL PARTS BEFORE USE FOR BREAKAGE OR FATIGUE. DISCONTINUE USE IMMEDIATELY IF ANY PART IS FOUND TO BE DAMAGED OR BROKEN
- YOUR VALCO BABY PRODUCT IS INTENDED FOR DOMESTIC USE ONLY. IT IS NOT INTENDED FOR COMMERCIAL USE.
- NEVER CARRY YOUR HITCHHIKER RIDE ON STAND WITH A CHILD ON.

AXLES ARE BEST LUBRICATED WITH GREASE OR PETROLEUM JELLY. MOVING PARTS ARE BEST LUBRICATED WITH SILICONE BASED PRODUCTS. DO NOT USE OIL BASED PRODUCTS.

valco  
baby

In Australia/New Zealand  
[www.valco.com.au](http://www.valco.com.au)

In North America only  
[www.valcobaby.com](http://www.valcobaby.com)  
1 800 610 7850